

Key Features:

- Center frequency range: 2.2~3.3GHz, bandwidth 100~300MHz
- Low VSWR, high power
- Size: 13.00x6.70x5.70 inches
- WR340 Waveguide, Cover flange type
- Cooling method: Air

Electrical Specifications

| Part No. | Freq Range MHz | VSWR | CW Power, Watts | Pulse Power Watts | Temp. Range, °C |
|----------------|----------------|----------|-----------------|-------------------|-----------------|
| TW3402-0240-08 | 2.30-2.50 | ≤ 1.1:1 | ≥ 500 | 30 kWatts | -40 ~ +70 |
| TW3402-0260-12 | 2.45-2.75 | ≤ 1.15:1 | ≥ 500 | 30 kWatts | -40 ~ +70 |
| TW4302-0290-07 | 2.80-3.00 | ≤ 1.1:1 | ≥ 500 | 30 kWatts | -40 ~ +70 |

Mechanical Structure:

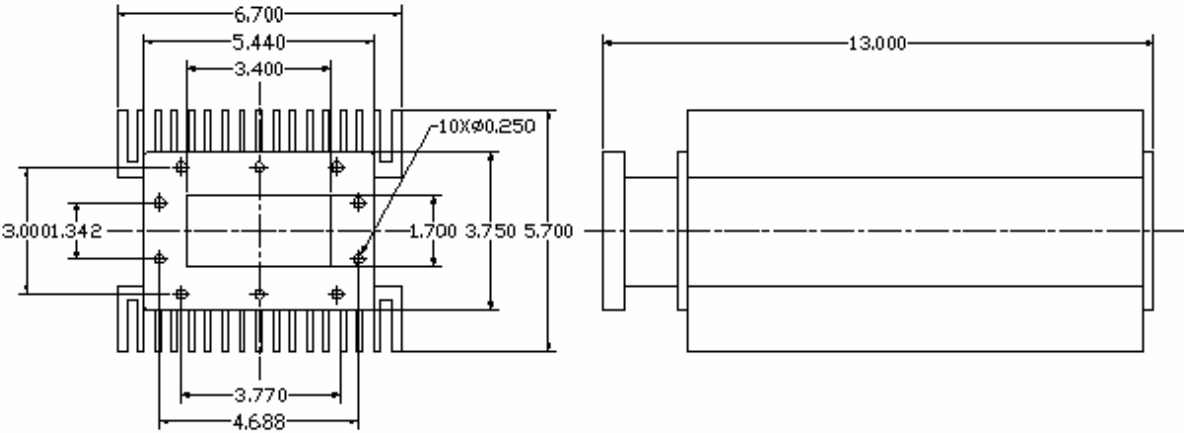

Note: All units in inches

Ordering Information:

